



CATALOG NUMBER	TYPE
PROJECT NAME	DATE

SPECIFICATIONS

FEATURES

- Architectural-grade exit sign with self diagnostics option
- Style is the difference

CONSTRUCTION

- Special plated alloy construction
- Choose from five metal finishes: silver, gold, satin nickel, antique brass, or bronze; contact factory for custom finishes
- Available in single or double face configurations
- EXIT letters are 6" tall with 3/4" stroke; 100 ft viewing distance

LAMP

- AllnGaP LEDs with a rated life of 10+ years

ELECTRONICS

- Dual-voltage input capability: 120/277V
- Low-voltage disconnect
- AC indicator light with test switch
- Brownout protection

BATTERY

- EM option comes standard with nickel-cadmium battery
- Provides a minimum of 90 minutes of illumination upon loss of power

COMPLIANCE

- Meets or exceeds UL 924, NFPA 101, NEC and OSHA illumination standards

WARRANTY

- 5-year warranty on housing and electronics. Battery is prorated

LB-U

SPECIAL PLATED EXIT SIGN



DIMENSIONS

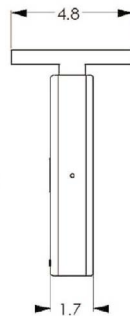
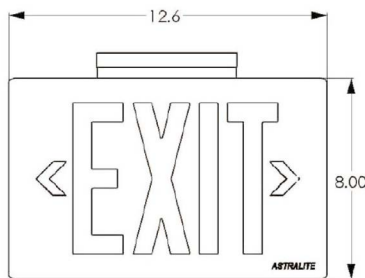

Material	Battery	Code Compliance	Dimensions
Plated Alloy	Nickel-cadmium	UL 924	12.6" W X 8" H X 4.8" D

ORDERING GUIDE

MODEL	LETTER COLOR	MOUNTING	CHEVRONS	HOUSING FINISH	POWER CONFIGURATION	OPTIONS
LB-U Contoured Plated Exit Sign	R Red G Green	1 Single Face Wall Mount 1C Single Face w/ Canopy 2C Double Face w/ Canopy 1E Single Face End Mount 2E Double Face End Mount	AL Arrow Left AR Arrow Right AB Arrows Left and Right NC No Chevrons	SI Silver GO Gold SN Satin Nickel AB Antique Brass BZ Bronze	AC AC Only EM Emergency DI Two Transformer Input	PK Pendant Kit