

DIMENSIONS

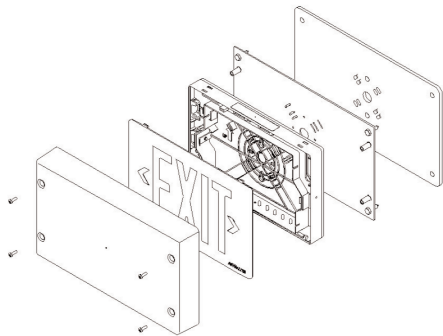
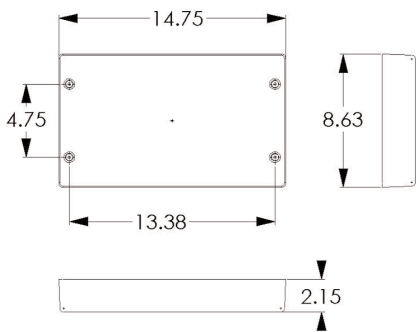

TYPE _____

CATALOG# _____

TP-VRS/4X-W

WALL MOUNT VANDAL RESISTANT / WATERPROOF EXIT

APPLICATION/DESCRIPTION

Astralite has combined durability and style with dedicated mounting of this vandal and impact resistant Exit Sign. Gone are the days with the generic bubbles or oversized wire guards lagged to the walls. This product is designed to blend nicely in any environment without obstructive guards or cages. Use in gymnasiums, schools, and correctional facilities or anywhere rugged protection is required.

HOUSING

Injection molded UV stabilized (.140") Thick polycarbonate precisely formed low profile dedicated to enclose our TP series self-powered Exit Sign. Mounts quickly and easily with a .100" thick wall stainless steel back plate.

VRS option includes Tamper Proof Mounting Screws.
4x Option includes Neoprene Gaskets suitable for Hosedown applications

ILLUMINATION

Long lasting high output AllInGaP LEDs with minimum degradation over life of LEDs. Unit draws less than 3 watts and meets all Energy Star Requirements. Available in red or green.

ELECTRONICS

Input is dual volt standard 120/277 60Hz. Unit is damp location listed 50°-104°F (10°-40°C). EM option features solid state design with low voltage disconnect, AC lockout, brown out protection, and AC indicator LED with test switch. Battery is standard Nickel Cadmium.

CODE COMPLIANCE

Tested and Listed to UL 924 for damp location, meets or exceeds NFPA, NEC, and OSHA illumination standard.

WARRANTY

5 years on housing and electronics with a 5 year pro rated warranty on the battery.

VANDAL & NEMA SERIES

TP

MODEL	MOUNTING	TYPE	LETTER COLOR	HOUSING COLOR	POWER CONFIGURATION	FACTORY INSTALLED OPTIONS
C	C = CEILING MOUNT E = END MOUNT W = WALL MOUNT	VRS = VANDAL RESISTANT 4X = WATER RESISTANT	R = RED G = GREEN	W = WHITE B = BLACK	AC = AC ONLY EM = EMERGENCY DI = TWO TRANSFORMER INPUT	FL = FLASHER ONLY. (BATTERY UNITS ONLY) FLASHES WHEN UNIT GOES INTO EMERGENCY CONDITION. FA = FIRE ALARM PANEL INTERFACE (AC AND BATTERY UNITS) FLASHES IN BOTH MODES WHEN SIGNAL FROM FIRE ALARM PANEL IS RECEIVED (6-24 VDC) FLA = FL OPTION WITH AUDIBLE ALARM. (BATTERY UNITS ONLY) FAA = FA OPTION WITH AUDIBLE ALARM. TPS = TAMPER-PROOF SCREWS (STANDARD FOR VRS) TPSD = TAMPER-PROOF SCREW DRIVER 220 = 220 VAC 50/60HZ INPUT

