

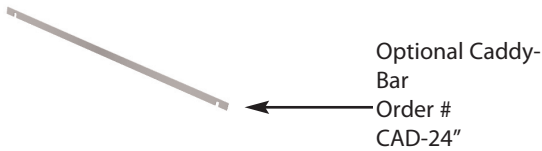

TP-300

Wall/Ceiling Mount

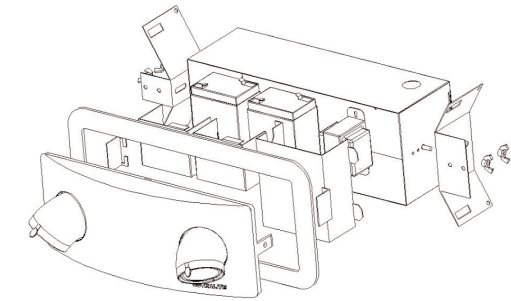
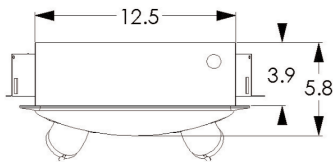
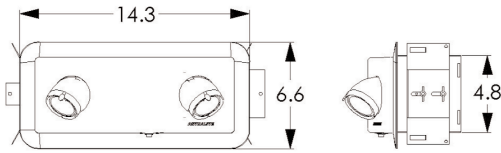

TYPE \_\_\_\_\_

CATALOG# \_\_\_\_\_

TP-300  
Semi Recessed Emergency Battery Unit  
Remote Capable

GENERAL DESCRIPTION

Redefining the aesthetic standards the industry has settled for in the past, the TP-300 Light Style™ series offers a high-performance and fully-adjustable Life Safety product with unique, gently contoured thermo plastic housing. Utilizing 2 MR-16 lamp heads, TP-300 provides the highest level of glare-free illumination while blending nicely into any environment. Unit features also remote capability to power an additional 16 Watt of remote heads.

HOUSING

UV Stable Thermo Plastic flame retardant lower housing, meets UL standard 95-VA. Rugged, heavy gauge, galvanized steel back box and easily installs in drywall or suspended ceilings. Suitable for use in air-handling plenums. Standard white or black finish (matches all products in same family.) Features 2 fully adjustable (360° rotation and 90° angle) MR-16 Halogen lamps with a maximum of 8 watts per.

ILLUMINATION

Two 5 Watt Standard ( 8 Watt Optional) MR-16 Halogen lamps mounted in precision formed fully adjustable assemblies exceed illumination required by UL 924 with better space to mounting criteria than the industry standard 5.4 Watt incandescent offering.

ELECTRONICS & BATTERY

Standard transformer input is dual voltage 120/277 60Hz. The charging system features (LVD) Low Voltage Disconnect, AC lockout installation and brown out protection and AC indicator LED light standard. The maintenance free sealed lead calcium battery provides a minimum of 90 minutes of illumination in emergency mode with an average life of 5 years. Optional Nickel Cadmium battery also available.

CODE COMPLIANCE

Tested and Listed to UL 924. Damp location listed. Meets or exceeds NFPA NEC and OSHA illumination standards.

WARRANTY

5 years on housing and electronics with a 5 year pro rated warranty on battery.

LIGHT STYLE™ SERIES

TP-300  
Model

\_\_\_\_\_  
Total Unit DC Wattage  
W/ Integral Lamps

\_\_\_\_\_  
Housing  
Color

\_\_\_\_\_  
Factory Installed  
Options

12	12 W TOTAL 2X5W INTEGRAL LAMPS
16	16 W TOTAL 2X8W INTEGRAL LAMPS
24	10 W 2 X 5W LAMPS & 14 W REMOTE
36	16 W 2 X 8W LAMPS & 16 W REMOTE

W	White
B	Black
GL	Gold
SL	Silver
R	Red
G	Green
BLU	Blue
Y	Yellow

NC	Nicad Battery
220	220 VAC Input
SD	Self Diagnostics
Cad-24	Caddy Bar
**TD	Time Delay
**Must Specify Input Voltage And Delay Time	

