



TYPE \_\_\_\_\_

CATALOG# \_\_\_\_\_

**TP-100-Plus**  
**Up To 25 (NICAD) Watts At 6 Volts**  
**Heavy Duty Remote Capable**  
**Emergency Battery Unit**



TP- 100-Plus

Wall Mount

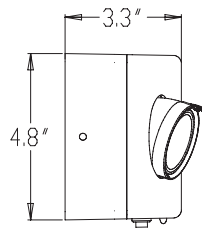
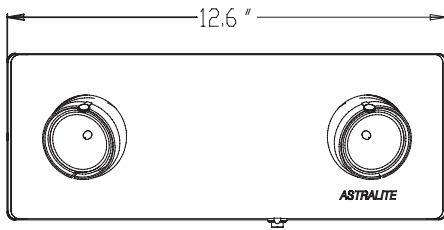

**GENERAL DESCRIPTION**

The Light Style™ Series TP-100-Plus thermo plastic unit is your solution to eliminate the unsightly toolbox design normally associated with remote capability. Unit features 2 fully adjustable MR16 lamps within a sleek contoured low profile design while allowing you up to 25 watts of total unit power.

**HOUSING**

UV Stable Thermo Plastic flame retardant meets UL standard 95-VA. Installation is one of the industry's fastest. Standard white or black finishes that which match all products in the same family. Patent pending.

**ILLUMINATION**

Two 5 Watt MR-16 Halogen lamps (10 Watt Optional) mounted in precision formed fully adjustable assemblies exceed illumination required by UL 924 with better space to mounting criteria than the industry standard 5.4 Watt incandescent offering.

**ELECTRONICS & BATTERY**

Standard transformer input is dual voltage 120/277 60Hz. The charging system features Low Voltage Disconnect (LVD), AC lockout installation, brown out protection, and standard AC indicator LED light. With an average life of 5 years, the maintenance free sealed lead calcium battery provides a minimum of 90 minutes of illumination in emergency mode. Optional Nickel Cadmium battery is also available.

**CODE COMPLIANCE**

Tested and Listed to UL 924. Meets or exceeds NFPA, NEC, and OSHA illumination standards.

**WARRANTY**

5 years on housing and electronics with a 5 year pro rated warranty on battery.

LIGHT STYLE™ SERIES

\*Note: To determine Maximum Remote Wattage, Subtract total integral lamp Watts from total DC Unit Wattage.  
 Example: 25 Watts (Total DC Wattage) minus 20 Watts (2X10 Watt Lamps) Equals 5 Watts Maximum available for remote lamps. So, this unit can run an additional 5 Watt remote lamp

TP-100-Plus	Total DC Wattage/ Batttery Type		Integral Lamps		Housing Color		Factory Installed Options	
Model	22 Watts	Sealed Led	-10	(2) 5 Watt MR16	W	White	220	220 VAC Input
	16 Watts	Nicad	-20	(2) 10 Watt MR16	B	Black	*A	Ammeter
	25 Watts	Nicad					*V	Voltmeter
							SD	Self Diagnostics
							CP	Canopy
							**TD	Time Delay
							Note: * Select one	
							** TD Must Specify AC	
							Input Voltage and Delay Time in Minutes.	

